



www.TheWorldTeamTrials.com

2013 World Team Trials Stillwater, OK

Athlete Packet

TABLE OF CONTENTS

| | |
|---|------------|
| Ticket Information | 3 |
| • Venue Seating Layout | |
| • Ticket Pricing | |
| • 2013 World Team Trials Ticket Information | |
| Official Event Housing..... | 4 |
| • Reservations | |
| Venue Information..... | 5 |
| • Driving Directions | |
| • Parking & Entry | |
| Media Information..... | 6 |
| • Media Accreditation | |
| • Pre-event News Conference | |
| • Post-match Interviews | |
| Athlete Technical & Operational Information | 6, 7 |
| • Weigh-in & Skin Checks | |
| • Athlete Escorts | |
| • Seeding Meetings | |
| • Practice Site | |
| • Uniforms | |
| • Drug Testing | |
| • Athlete/Coaches Seating Area | |
| Accreditation..... | 8 |
| • Credential Pick-up | |
| • Coaches Credentials | |
| • Trainers/Medical Staff Credentials | |
| Event Schedule..... | 9, 10 |
| Athlete Registration Form..... | Appendix 1 |
| Additional Credential Form..... | Appendix 2 |
| 2013 World Team Trials First Floor Diagram | Appendix 3 |
| 2013 World Team Trials Second Floor Diagram | Appendix 4 |
| 2013 World Team Trials In Arena Diagram..... | Appendix 5 |
| 2013 World Team Trials Consent and Waiver Form..... | Appendix 6 |

TICKET INFORMATION

Venue Layout

- The venue layout for Gallagher-Iba Arena is available below.
- Preliminary matches through the semi-finals and third place matches will be featured on four (4) mats.
- The True Third place matches will be on all four mats at the beginning of the evening session
- The Final World Team trials matches will take place on two mats.
- Head table and media will be on the west side of floor.
- VIP seating will be sat in sections 101 – 102 – 103.
- Athletes will sit in section 207 & 208.
- Medical will be setup Gallagher-Iba Arena Training Room in the NW corner of building.
- Refer to the appendix for another venue diagram with more detail.

Ticket Pricing Information

All Session Floor Seating: *\$100.00

All Session Reserved Seating: *\$50.00

All Session General Admission Seating: *\$30.00

(All Session includes all 4 sessions of World Team Trials)

Single Day Floor Seating: *\$40.00

Single Day Reserved Seating: *\$20.00

Single Day General Admission Seating: *\$15.00

(Single Day includes 2 sessions of World Team Trials)

***Note: Additional ticket fees may apply**

Tickets available on OKState.com and at the Arena Box Office

To purchase tickets visit www.theworldteamtrials.com or www.okstate.com. Only all-session tickets are available for purchase at this time. Single Day tickets will go on sale the week of the event.

OFFICIAL EVENT HOUSING

(ASK FOR THE WORLD TEAM TRIALS RATE WHEN MAKING RESERVATIONS)

Atherton Hotel at OSU

H103 Oklahoma State University Student Union
Stillwater, OK 74078
Contact: Monica Casey
Phone: 405-744-6835
Rate: \$98.00
Drop Date: 5/20/2013

Best Western Cimarron Hotel & Suites

315 N. Husband St.
Stillwater, OK 74075
Contact: Leah McIntyre
Phone: 405-372-2878
Rate: \$115.00 – includes hot breakfast buffet
Drop Date: 5/20/2013

Fairfield Inn

418 E. Hall of Fame Ave.
Stillwater, OK 74075
Contact: Katy Lollis
Phone: 405-372-6300
Rate: \$94.99
Drop Date:

La Quinta

5285 W. 6th Ave.
Stillwater, OK 74704
Contact: Keli Reid
Phone: 405-564-0599
Rate: \$109.00
Drop Date: 6/6/2013

Microtel Inn & Suites

423 E. Hall of Fame Ave.
Stillwater, OK 74075
Contact: Georgia Stanley
Phone: 405-372-7100
Rate: \$99.95-125.95 – breakfast included
Drop Date: 6/1/2013

Residence Inn

800 S. Murphy St.
Stillwater, OK 74074
Contact: Jan Harris
Phone: 405-707-0588
Rate: \$114.00
Drop Date: 6/1/2013

VENUE INFORMATION

Directions

Gallagher-Iba Arena is on the campus of Oklahoma State University. Stillwater, the home of Oklahoma State University, is approximately one hour north-northeast of Oklahoma City, and a little over an hour west of Tulsa. Most OSU athletic facilities can be accessed via Hall of Fame Avenue in Stillwater.

From Oklahoma City (Will Rogers Airport):

Suggested Route I-35 North (about 75 miles)

1. Head southeast on Terminal Dr toward Air Cargo Rd
2. Slight right to stay on Terminal Dr
3. Slight right at S Meridian Ave
4. Take the Eb/OK-152 ramp to DOWNTOWN/I-44
5. Merge onto OK-152 E
6. Take the exit onto I-44 E/OK-3 W toward Tulsa
7. Take the I-44/OK-66 exit toward I-35/Wichita/Tulsa
8. Continue straight onto I-44 E/OK-66 E
9. Continue on I-35 N
10. Take exit 174 for OK-51 toward Hennessey/Stillwater
11. Keep right at the fork to continue toward 6th St/OK-51 and merge onto 6th St/OK-51
12. Continue to follow OK-51 into Stillwater

From Tulsa (Tulsa International Airport):

Suggested Route OK-51 West - [NO TOLL] (about 72 miles)

1. Head northwest on Airport Rd/Airport Dr toward N 75th E Ave
Continue to follow Airport Rd
2. Take the ramp onto OK-11 W
3. Take the exit onto US-75 S toward Okmulgee
4. Take the exit on the left onto I-244 W/US-412 W
5. Continue on US-412 W (signs for Sand Springs/US-412/Enid/OK-51/US-64)
6. Take the exit toward Mannford/Stillwater/OK-51
7. Merge onto S Hwy-151/OK-151
8. Take the ramp onto W Hwy-51/OK-51
9. Continue to follow OK-51 into Stillwater

From Wichita, KS (Wichita Mid-Continent Airport):

Suggested Route I-35 South (about 132 miles)

1. Head west on Airport Service Rd toward S Tyler Rd
2. Turn right at S Tyler Rd
3. Turn right at W Kellogg Dr
4. Take the ramp on the left onto US-400 E/US-54 E
5. Take the exit onto I-235 S
6. Take the exit onto I-135 S toward I-35/Kansas Turnpike
7. Take the exit onto I-35 S/Kansas Turnpike toward Oklahoma City
Continue to follow I-35 S
8. Take exit 174 for OK-51 toward Stillwater/Hennessey
9. Turn left at 6th St/OK-51
10. Continue to follow OK-51 to Stillwater

Parking

Parking will be available to athletes and coaches on the south side of Gallagher-Iba Arena in the gravel parking lot. Parking passes will be available at registration. General fan parking will be on the south side of Gallagher-Iba Arena and the south side of Boone Pickens Stadium.

MEDIA INFORMATION

Media Accreditation

Media who are interested in covering the 2013 World Team Trials for wrestling should contact Press Chief Gary Abbott at (719) 598-8181 or gabbott@usawrestling.org. Media credential applications must be received by June 7, 2013.

Pre-Event News Conference

USA Wrestling and the Local Organizing Committee are planning a pre-event press conference for Thursday, June 20. The site and time of this news conference are to be determined. A number of athletes may be asked to participate upon request from Gary Abbott of USA Wrestling. Further details will be provided at a later date.

Post-Match Interviews

The World Team Trials will utilize a mix zone for interviews, similar to how it is done at larger International competitions. After each match, athletes will be escorted through the mix zone, where journalists may ask questions. The USA Wrestling Communications staff will also be there to assist athletes in managing this. Formal post-match interviews will follow the Challenge Tournament and also the Championship Finals Series matches. Some athletes may also be taken to a press conference area after their championship series.

ATHLETE TECHNICAL & OPERATIONAL INFORMATION

Weigh-in/Medical Checks

Medical checks will take place in the Auxiliary Gym at 2:15pm to 2:30pm with weigh-ins immediately following from 2:30pm to 3:00pm. The schedule for medical checks and weigh-ins are as follows:

THURSDAY, JUNE 20

Medical Check @ Gallagher-Iba Arena – Auxiliary Gym..... 2:15 pm – 2:30 pm
Men’s Freestyle: 60 KG, 74 KG, and 96 KG
Greco-Roman: 55 KG, 66 KG, 84 KG and 120 KG
Women’s Freestyle: 55 KG and 72 KG

Weigh-in @ Gallagher-Iba Arena – Auxiliary Gym..... 2:30 pm – 3:00 pm
Men’s Freestyle: 60 KG, 74 KG, and 96 KG
Greco-Roman: 55 KG, 66 KG, 84 KG and 120 KG
Women’s Freestyle: 55 KG and 72 KG

FRIDAY, JUNE 21

Medical Check @ Gallagher-Iba Arena – Auxiliary Gym..... 2:15 pm – 2:30 pm
Men’s Freestyle: 55 KG, 66 KG, 84 KG and 120 KG
Greco-Roman: 60 KG, 74 KG, and 96 KG
Women’s Freestyle: 48 KG and 63KG

Weigh-in @ Gallagher-Iba Arena – Auxiliary Gym..... 2:30 pm – 3:00 pm
Men’s Freestyle: 55 KG, 66 KG, 84 KG and 120 KG
Greco-Roman: 60 KG, 74 KG, and 96 KG
Women’s Freestyle: 48 KG and 63 KG

Athlete Escorts

All wrestlers and coaches will be escorted to and from the main arena. No wrestler or coach will be permitted to sit or stand around the wrestling field of play. Wrestlers and coaches will be escorted to and from the warm-up area, staging area and field of play via athlete escorts. Call to mat system/monitors will be used in the warm-up area and staging area to assist the wrestlers and coaches when to move to the field of play.

Seeding Meetings

Seeding meetings will be held in the Gallagher-Iba Arena Theatre Room at 3:00pm. See the following schedule for times, dates and meeting rooms of each meeting.

THURSDAY, JUNE 20TH

Seeding Meetings @ Gallagher-Iba Arena Theatre Room (Rm 156)..... 3:00 pm
Men's Freestyle: All weights
Greco-Roman: All weights
Women's Freestyle: All weights

FRIDAY, JUNE 21ST

Seeding Meetings (if needed) @ Gallagher-Iba Arena Theatre Room (Rm 156)..... 3:00 pm
Men's Freestyle: 55 KG, 66 KG, 84 KG and 120 KG
Greco-Roman: 60 KG, 74 KG, and 96 KG
Women's Freestyle: 48 KG and 63 KG

Practice Site

On Wednesday, June 8th, the workouts will be held at Gallagher Iba Arena – Auxiliary Gym. On June 20th and 21st, the workouts will be held at Gallagher Iba Arena – Auxiliary Gym. The practice site has three (2) wrestling mats. Only athletes, coaches and work-out partners, **with credentials**, will only be admitted in the practice site. **NO EXCEPTIONS!** Gallagher Iba Arena has a Sauna that athletes and clubs can have access to during the event. The Sauna is located on the 2nd floor of Gallagher Iba Arena in the NW corner of building (see Appendix 4). **All work-out partners can obtain a work-out credential at accreditation for a cost of \$40.** This credential will include entry into the main arena in the athlete seating area. Requests for work-out credentials (names of work-out partner) must appear on the Registration Form. Credentials will be produced in advance. **Payment for each credential must be made at accreditation.**

Practice Site Dates/Hours of Operations:

| | |
|---------------------------------|------------------|
| Thursday, June 20 th | 5:00pm to 8:00pm |
| Friday, June 21 st | 9:00am to 8:00pm |
| Saturday, June 22 nd | 9:00am to 8:00pm |

Uniforms

HIGH CUT SINGLETs are required at the 2013 World Team Trials. There will be no exceptions. Only blue or red singlets will be permitted. Women must wear women's cut singlets.

Drug Testing

As in the past, all finalists, of each weight class, will be drug tested by USADA. This will occur in the arena immediately following the finals matches each night.

Athlete/Coaches Seating Area

Athletes and coaches will be provided a separate seating area during the World Team Trials. Only accredited athletes/coaches will be permitted to sit in the designated Athlete/Coaches seats. Athlete/Coaches credentials will not be permitted to sit in the spectator sections of the venue.

ACCREDITATION

Credential Pick-up

ALL ATHLETES NEED TO SUBMIT A HEADSHOT (PREFERABLY JPEG 300 PIXELS TALL X 200 PIXELS WIDE) WITH THEIR REGISTRATION. HEADSHOTS SHOULD BE EMAILED TO PISAIS@USAWRESTLING.ORG NO LATER THAN FRIDAY, JUNE 7, 2013. Credentials can be picked up at the **Gallagher-Iba Arena – SW Lobby**.

Credentials will be provided to athletes, coaches and all individuals directly involved in event operations. Credentials must be worn at all times while in the competition and practice venues. Athletes/coaches entering the arena may only enter at the designated athlete/coach entrance.

Credential Pick-up Times

Athlete, Coach and Team Support credentials will be issued at Gallagher-Iba Arena during the following schedule.

Credential Pick-up Times/Hours of Operations:

| | |
|----------------------------------|------------------|
| Wednesday, June 19 th | 5:00pm to 8:00pm |
| Thursday, June 20 th | 9:00am to 6:00pm |
| Friday, June 21 st | 9:00am to 3:00pm |

Coaches Credentials

In order to provide the best competition environment while accommodating all participating athletes, USA Wrestling has established a specific policy regarding coaches' credentials at the 2013 USA Wrestling World Team Trials. Each club with multiple athletes will be allowed up to **five (5)** non-transferable coach's credentials. Athletes wrestling unattached or single athletes from a club will be allowed up to **two (2)** non-transferable coach's credentials.

| <u>Number of Athletes</u> | <u>Number of Coaches Credentials</u> |
|---------------------------|--------------------------------------|
| 1-3 | 2 |
| 4 | 3 |
| 5+ | 5 |

Enclosed in this packet is the Coaches Credential Application. Please fax this form to Pete Isais by **June 7** to request all coaches' credentials. **PLEASE NOTE: THERE WILL BE A DESIGNATED VIDEO TAPING AREA ON THE COMPETITION FLOOR. VIDEO TAPING PERSONNEL MUST HAVE A COACH'S CREDENTIAL IN ORDER TO GAIN ACCESS TO THE COMPETITION FLOOR. PERSONNEL VIDEO TAPING MATCHES OUTSIDE OF THE DESIGNATED VIDEO TAPING AREA WILL BE EJECTED FROM THE COMPETITION FLOOR.**

In the event a club requires more than five (5) coaches, please submit a list of additional coaches with USAW Coaches membership card numbers to USA Wrestling. Requests will be considered on an individual basis. Fax or email your coaches' names, along with their USA Wrestling Coaches Membership card number, to USA Wrestling, attention Pete Isais, by June 7. Fax: (719) 598-9440 or email Pisais@usawrestling.org. You will be notified of your approved list by June 11.

Trainers/Medical Staff Credentials

Please note that USA Wrestling/Local Organizing Committee will provide medical staff at the event. If you/your club are/is bringing trainers or medical staff, please include their names and additional information along with your coaches credential request. You will be notified of your approved list by **Tuesday, June 11, 2013**.

2013 US World Team Trials

Event Schedule

THURSDAY, JUNE 20

Weigh-in Card Pick-up (All Weights) @ Gallagher Iba Arena – Auxiliary Gym1:00 pm – 2:30 pm

Medical Check @ Gallagher Iba Arena – Auxiliary Gym.....2:15 pm – 2:30 pm

Men's Freestyle: 60 KG, 74 KG, and 96 KG

Greco-Roman: 55 KG, 66 KG, 84 KG, and 120 KG

Women's Freestyle: 55KG and 72KG

Weigh-in @ Gallagher Iba Arena – Auxiliary Gym.....2:30 pm – 3:00 pm

Men's Freestyle: 60 KG, 74 KG, and 96 KG

Greco-Roman: 55 KG, 66 KG, 84 KG, and 120 KG

Women's Freestyle: 55KG and 72KG

Seeding Meetings @ Gallagher Iba Arena – Theatre Room – Rm 156.....3:00 pm

Men's Freestyle: All weights

Greco-Roman: All weights

Women's Freestyle: All weights

Mat Officials Meeting @ Gallagher Iba Arena – Varsity Room (2nd floor Rm 263).....3:00 pm

Federation of Clubs Meeting @ Gallagher Iba Arena – Theatre Room – Rm 156.....4:00pm - 5:30pm

FRIDAY, JUNE 21

Men's Freestyle: 60 KG, 74 KG, and 96 KG

Greco-Roman: 55 KG, 66 KG, 84 KG, and 120 KG

Women's Freestyle: 55KG and 72KG

SESSION I - Preliminaries, Quarterfinals, Semifinals, Challenge Finals/Consolations and 3rd Place 11:00 am – 4:00 pm

Challenge Tournament Finals (All women's freestyle weights;

Men's freestyle and Greco-Roman as necessary)

SESSION II – Final World Team Trials and True Third place matches 6:30 pm – 9:00 pm

Men's Freestyle: 60 KG, 74 KG and 96 KG

Greco-Roman: 55 KG, 66 KG, 84 KG, and 120 KG

Women's Freestyle: 55KG and 72KG

Weigh-in Card Pick-up @ Gallagher Iba Arena – Auxiliary Gym1:00 pm – 2:30 pm

Medical Check @ Gallagher Iba Arena – Auxiliary Gym.....2:15 pm – 2:30 pm

Men's Freestyle: 55 KG, 66 KG, 84 KG and 120 KG

Greco-Roman: 60 KG, 74 KG, and 96 KG

Women's Freestyle: 48 KG and 63 KG

Weigh-in @ Gallagher Iba Arena – Auxiliary Gym.....2:30 pm – 3:00 pm

Men's Freestyle: 55 KG, 66 KG, 84 KG and 120 KG

Greco-Roman: 60 KG, 74 KG, and 96 KG

Women's Freestyle: 48 KG and 63 KG

Seeding Meetings (if needed) @ Gallagher Iba Arena – Auxiliary Gym.....3:00 pm

Men's Freestyle: 55 KG, 66 KG, 84 KG and 120 KG

Greco-Roman: 60 KG, 74 KG, and 96 KG

Women's Freestyle: 48 KG and 63KG

Parade of Past World Team Members (immediately following first round of finals matches).....6:45pm

SATURDAY, JUNE 22

Men’s Freestyle: 55 KG, 66 KG, 84 KG and 120 KG

Greco-Roman: 60 KG, 74 KG, and 96 KG

Women’s Freestyle: 48 KG and 63 KG

SESSION I - Preliminaries, Quarterfinals, Semifinals, Challenge Finals/Consolations and 3rd Place 11:00 am – 4:00 pm
Challenge Tournament Finals (All women’s freestyle weights; Men’s freestyle and Greco-Roman as necessary)

Awards Luncheon – Training Table..... 4:00 pm – 6:00 pm

SESSION II – Final World Team Trials and True Third place matches 6:00 pm – 8:00 pm

Men’s Freestyle: 55 KG, 66KG, 84 KG and 120 KG

Greco-Roman: 60 KG, 74 KG, and 96 KG

Women’s Freestyle: 48 KG and 63 KG

PRESENTATION OF THE 2013 WORLD CHAMPIONSHIP TEAMS

For questions on specific style criteria concerning the World Team Trials, contact Mitch Hull, USA Wrestling Director of National Teams, at (719) 598-8181 or mhull@usawrestling.org.

APPENDIX 1

WORLD TEAM TRIALS Stillwater, OK June 20-23, 2013 *Athlete Registration Form*

Athletes and coaches who fail to register by **Friday, June 7, 2013**, will be charged a \$40.00 late processing fee per credential to attend the 2013 World Team Trials. This processing fee is payable prior to obtaining a credential. Requests for credentials must appear on this Registration Form. All credentials are produced in advance. **ALL ATHLETES NEED TO SUBMIT A HEADSHOT (PREFERABLY JPEG 300 PIXELS TALL X 200 PIXELS WIDE) WITH THEIR REGISTRATION. HEADSHOTS SHOULD BE EMAILED TO PISAIS@USAWRESTLING.ORG NO LATER THAN FRIDAY, JUNE 7, 2013.**

CLUB/TEAM: _____

Date: _____

Contact Person _____

Phone Number: _____

Cell Phone Number: _____

Email Address: _____

MAKE DUPLICATE COPIES AS NEEDED

| <u>Athlete Name</u> | <u>Weight</u> | <u>Style</u> (Circle) | <u>Athlete USA Card #</u> |
|---------------------|---------------|--------------------------|---------------------------|
| _____ | _____ | FS / GR / WMFS | _____ |
| _____ | _____ | FS / GR / WMFS | _____ |
| _____ | _____ | FS / GR / WMFS | _____ |
| _____ | _____ | FS / GR / WMFS | _____ |
| _____ | _____ | FS / GR / WMFS | _____ |
| _____ | _____ | FS / GR / WMFS | _____ |
| _____ | _____ | FS / GR / WMFS | _____ |
| _____ | _____ | FS / GR / WMFS | _____ |
| _____ | _____ | FS / GR / WMFS | _____ |
| _____ | _____ | FS / GR / WMFS | _____ |
| _____ | _____ | FS / GR / WMFS | _____ |
| _____ | _____ | FS / GR / WMFS | _____ |
| _____ | _____ | FS / GR / WMFS | _____ |
| _____ | _____ | FS / GR / WMFS | _____ |
| _____ | _____ | FS / GR / WMFS | _____ |
| _____ | _____ | FS / GR / WMFS | _____ |

NOTICE: Please fill in the form with print characters. You can either fax it to Pete Isais at (719) 598-9440 or email similar spreadsheet with required data to pisais@usawrestling.org by **Friday, June 7, 2013**. Athletes and coaches who fail to register by **Friday, June 7, 2013**, will be **CHARGED a \$40.00 late processing fee per credential** to attend the 2013 World Team Trials. This processing fee is payable prior to obtaining a credential.

APPENDIX 2

WORLD TEAM TRIALS Stillwater, OK June 20-23, 2013 *Additional Credential Form*

NOTICE: Please fill in the form with print characters. You can either fax it to Pete Isais at (719) 598-9440 or email similar spreadsheet with required data to pisais@usawrestling.org by **Friday, June 7, 2013**. Athletes and coaches who fail to register by **Friday, June 7, 2013**, will be **CHARGED a \$40.00 late processing fee per credential** to attend the 2013 World Team Trials. This processing fee is payable prior to obtaining a credential. **PLEASE NOTE: THERE WILL BE A DESIGNATED VIDEO TAPING AREA ON THE COMPETITION FLOOR. VIDEO TAPING PERSONNEL MUST HAVE A COACH'S CREDENTIAL IN ORDER TO GAIN ACCESS TO THE COMPETITION FLOOR. PERSONNEL VIDEO TAPING MATCHES OUTSIDE OF THE DESIGNATED VIDEO TAPING AREA WILL BE EJECTED FROM THE COMPETITION FLOOR.**

CLUB/TEAM: _____ **Date:** _____
Contact Person _____ **Phone Number:** _____
Cell Phone Number: _____ **Email Address:** _____

MAKE DUPLICATE COPIES AS NEEDED

PLEASE BE AWARE OF THE COACHES FORMULA (See page 6)

Coach: _____ USA Coaches Card Number: _____
Coach: _____ USA Coaches Card Number: _____
Coach: _____ USA Coaches Card Number: _____
Coach: _____ USA Coaches Card Number: _____
Coach: _____ USA Coaches Card Number: _____
Trainer: _____

Work-out Partner credentials must be purchased. The cost for these credentials is \$40.00, payable at accreditation. These credentials allow access to the training room and seating in the athlete area only. Credentials will be produced in advance. Requests for work-out credentials (names of work-out partner) must appear on this page. All work-out partners must be a current USAW member. **Payment for each credential must be made at accreditation.**

| <u>Wrestler Requesting Credential</u> | <u>Name of Workout Partner</u> | <u>Membership Card Number</u> |
|---------------------------------------|--------------------------------|-------------------------------|
| _____ | _____ | _____ |
| _____ | _____ | _____ |
| _____ | _____ | _____ |
| _____ | _____ | _____ |

APPENDIX 3

2013 WORLD TEAM TRIALS FIRST FLOOR DIAGRAM

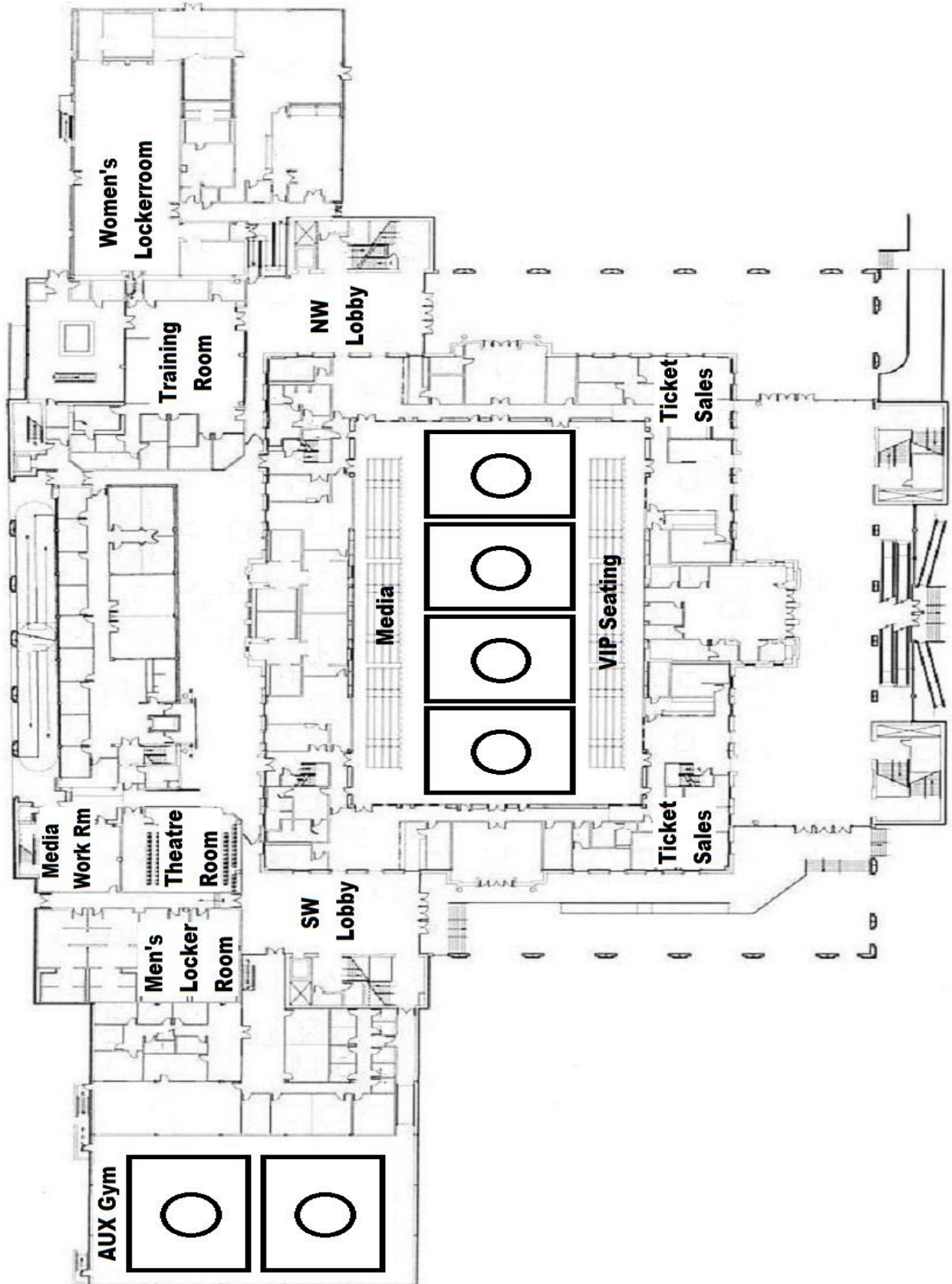

APPENDIX 4

2013 WORLD TEAM TRIALS SECOND FLOOR DIAGRAM

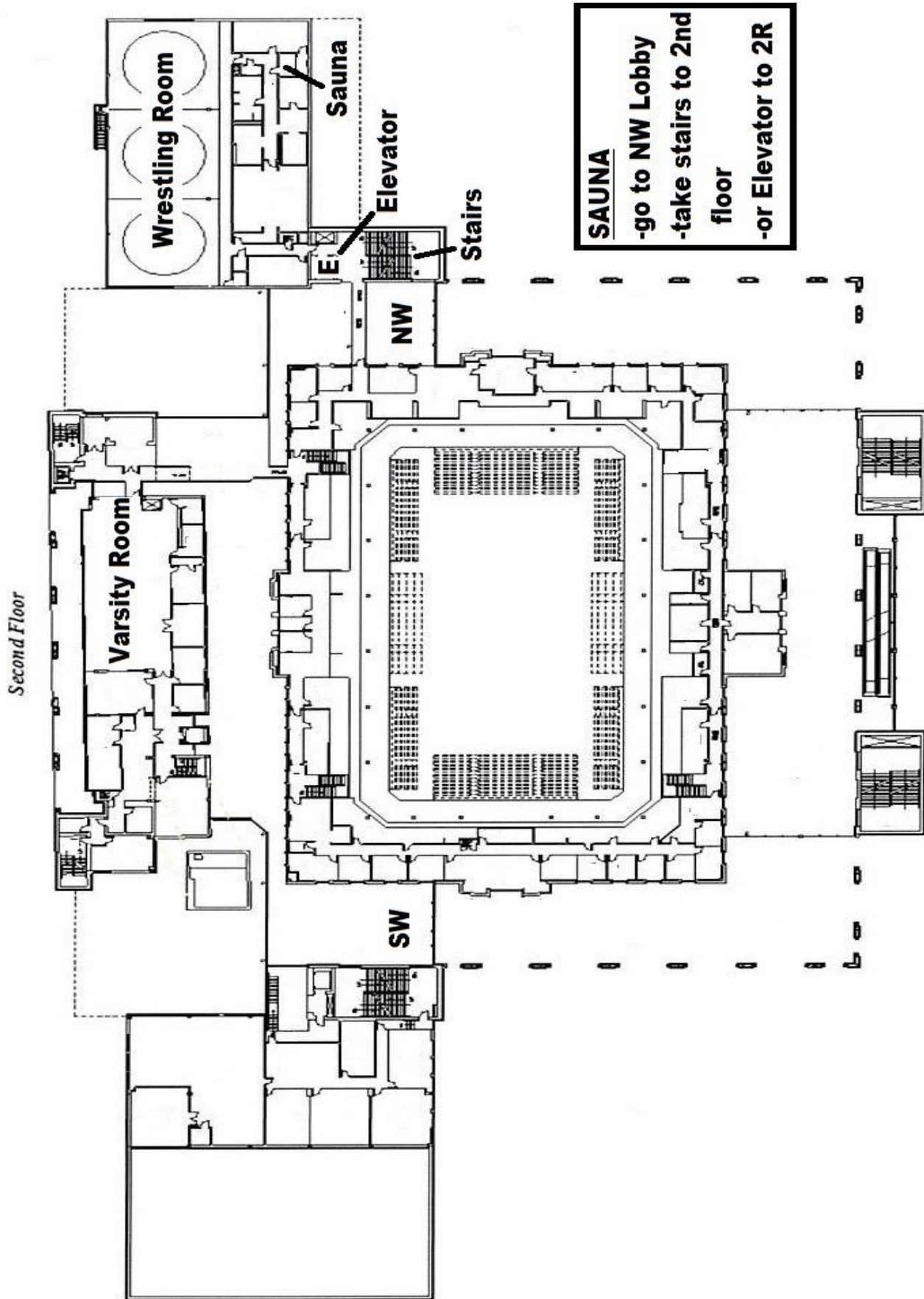

APPENDIX 5

2013 WORLD TEAM TRIALS IN ARENA DIAGRAM

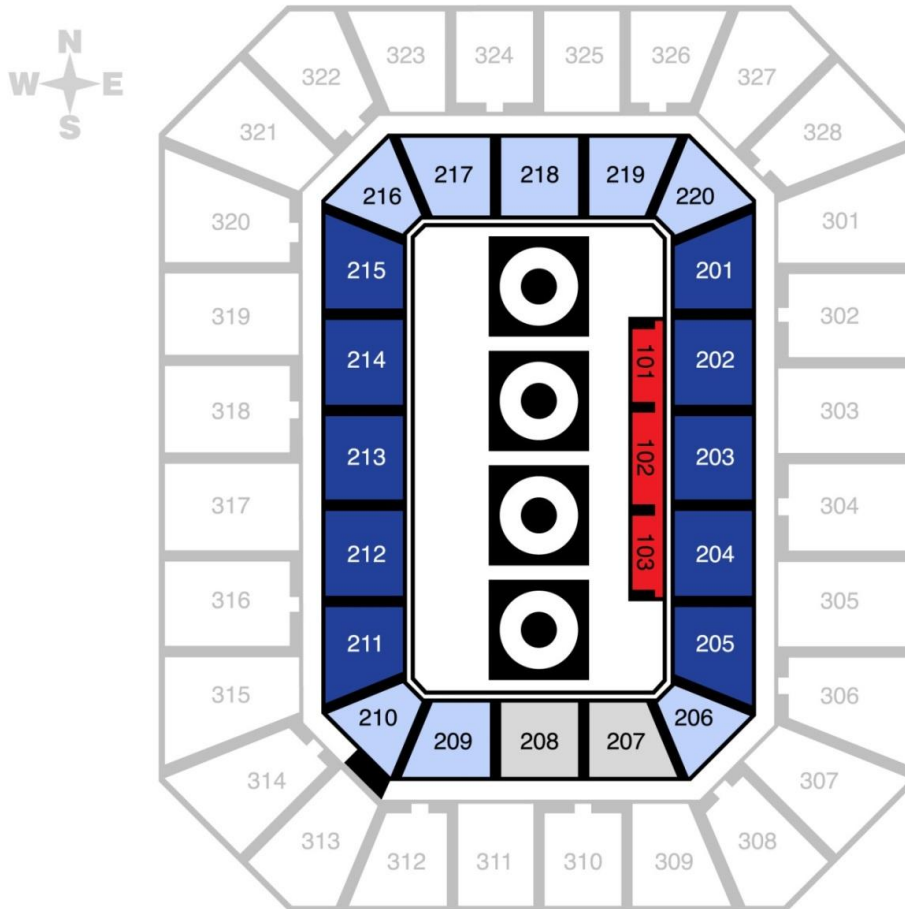

ALL SESSION TICKETS

www.TheWorldTeamTrials.com

- Mat-side 100-Level\$100
- Reserved 200-Level\$50
- General Admission.....\$30
- Participant Seating

877-ALL-4-OSU
okstate.com/tickets
 @okstatetix

APPENDIX 6

Consent and Waiver Form

MEDICAL CONSENT

Parent or Guardian of minor must read and complete the following:

Without this signed authorization from the parent/guardian, hospitals in many states are obligated by law to delay treatment of a contestant's injury or illness until the parents can be reached by telephone and their permission granted to begin treatment. Such a delay can prove unnecessarily painful and even dangerous to the athlete, particularly if the parents cannot be reached immediately. To avoid such delays, the parent/guardian should check one of the options below and endorse the selection with his/her signature.

Check one:

If my child needs medical attention, it is my wish that I be contacted before any medical procedures are begun, unless immediate medical treatment is necessary to save my child's life or prevent permanent injury, in which event I authorize all necessary treatment.

If my child, named above, needs medical treatment during this event, it is my wish that the necessary treatment be initiated while efforts are being made to contact me. So that treatment of my child will not be delayed, I consent to any medical procedures that the physician believes my child needs, on the understanding that efforts will continue to be made to reach me. I accept responsibility for all costs related to such treatment.

Adult athletes hereby authorize and consent to emergency medical treatment. Exceptions — List any medical procedures that you do not want performed unless specific approval is received:

Name of Primary Insurance Company _____

Name _____

USAW Card # _____

Policy # _____

Address _____

Address _____

City _____

Family Doctor _____

State _____ Zip _____

Phone _____

Phone _____ Birth Date _____

Presently on any medication? _____

E-mail _____

Grade _____ Weight Class _____

If yes, please list medication(s) _____

School/Club _____

Drug Sensitivities or Allergies _____

Please check the style you plan to participate.

Senior Mens Freestyle
(Born 1883 or before, 1884-1886 with Medical Certificate)

Senior Greco-Roman
(Born 1883 or before, 1884-1886 with Medical Certificate)

Senior Womens Freestyle
(Born 1883 or before, 1884-1886 with Medical Certificate)

Special Medical Conditions _____

Please indicate another person to call in case of emergency

Name _____

Phone _____

PARTICIPANT ACKNOWLEDGES THAT PARTICIPANT HAS HAD SUFFICIENT OPPORTUNITY TO REVIEW THE PROVISIONS OF THIS DOCUMENT AND UNDERSTANDS ITS PURPOSE, MEANING AND INTENT.

Print Name of Participant _____

Signature of Participant _____ Date _____

Signature of Parent or Guardian _____ Date _____

Consent & Release Form and Assumption of Risk, Code of Conduct & Release of Liability Waiver

CONSENT AND RELEASE FORM

In consideration for the opportunity to participate in the 2013 WORLD TEAM TRIALS (the "Event") the undersigned and his/her parent or guardian, if applicable ("Participant") hereby acknowledges that the "Event," and related activities and performances, may be televised live and/or videotaped for broadcast, cable cast, home video entertainment and/or any other use or distribution (collectively, "Dissemination") in a manner not inconsistent with applicable rules of The United States of America Wrestling Association, Inc., d/b/a USA Wrestling, Inc. ("USAW") and/or the Fédération Internationale des Luttes Associées ("FILA") and hereby consents that USAW, for purposes of USAW's athletics/sports programs and related events and activities, and any television network, production company or any other parties with which USAW has agreements for such purposes, and/or their licensees, shall have the right, without any compensation to participant, to use Participant's name, photograph, image, likeness, biography and accomplishments and displays of wrestling ability in any Dissemination of the Event and for the purpose of advertising, promoting and publicizing the events and activities of USAW and the program and/or any program series of which any Dissemination of the Event is a part (provided that none of the above shall be used in such fashion so as to constitute an endorsement of any commercial product). Participant agrees, for and on behalf of Participant and Participant's heirs, personal representatives, administrators, agents, successors and assigns, to release, indemnify and hold harmless USAW and its officers, directors, agents, employees and licensees from any claim of any nature based upon or arising out of any Dissemination or other permitted uses contemplated by this Consent and Release.

Signature of Participant _____ Date _____

Signature of Parent or Guardian _____ Date _____

ASSUMPTION OF RISK, CODE OF CONDUCT & RELEASE OF LIABILITY WAIVER

IN CONSIDERATION FOR the opportunity to participate in the EVENT described below, PARTICIPANT acknowledges, agrees and affirms the following:

- The following words used in this document will have the meaning indicated:
 - "EVENT" shall mean the 2013 WORLD TEAM TRIALS.
 - "USAW" shall mean The United States of America Wrestling Association, Inc., d/b/a USA Wrestling, Inc., and its directors, officers, members, employees, officials, committees, clubs, affiliates, agents and their successors and assignees.
 - "EVENT ORGANIZER" shall mean a club, local organizing committee or any other person or entity responsible for hosting, conducting, and/or sponsoring the EVENT, including any director, officer, member, official, committee or agent thereof and their successors and assignees.

D. "PARTICIPANT" shall mean the undersigned individual who competes or is involved in the EVENT and his/her parents, legal guardians, heirs, personal representatives and their successors and assignees.

E. "PERSONAL INJURY" shall mean and include any bodily injury; permanent, temporary, total or partial disability; paralysis; dismemberment; or death.

F. "PROPERTY DAMAGE" shall mean and include damage or destruction to PARTICIPANT'S gear, equipment and all other personal property or belongings.

G. "MEDICAL TREATMENT" shall mean and include all emergency medical treatment, medical procedures, hospitalization or other care rendered to PARTICIPANT in connection with or resulting from his/her participation in EVENT.

H. "LOSS" shall mean and include any and all liabilities, losses, damages and claims (including reasonable costs and attorneys' fees), which are suffered or result directly or indirectly from PERSONAL INJURY, PROPERTY DAMAGE and/or MEDICAL TREATMENT to PARTICIPANT, or others, and which are incurred during or in the course of PARTICIPANT'S preparation for, participation and involvement in, and travel to or from the EVENT or the conduct and management of the EVENT.

2. By issuing a sanction for the EVENT, USAW is not responsible or liable for the management or conduct of the EVENT, unless USAW has otherwise expressly agreed in writing to serve in such role.

3. PARTICIPANT understands and appreciates the risks of serious injury that may occur in the sport of wrestling or in the course of preparing for, participating in and traveling to or from the EVENT, and that such activities may involve risks, including PERSONAL INJURY.

4. PARTICIPANT knowingly and voluntarily assumes all such risks of LOSS and all legal and financial responsibility therefor.

5. USA Wrestling (USAW) is committed to providing a safe environment for its members, participants, coaches, officials and volunteers and to prevent abusive conduct and harassment in any form while participating in the activities of USAW. USAW promotes good sportsmanship throughout the organization and encourages qualities of mutual respect, courtesy and tolerance in all members, participants, coaches, officials, staff and volunteers. USAW advocates building strong self-images among participants. Athletes with a strong self-image may be less likely targets for abuse or harassment; similarly, they may be less likely to engage in abuse or to harass or bully others around them.

To this end, USAW has established the following guidelines of behavior. All members of the organization, as well as parents, spectators and other invitees are expected to observe and adhere to these guidelines.

Harassment and abuse are defined in various sources such as state law, case law, sports organization and professional association codes of conduct and training manuals, corporate and business workplace documents and human rights commission materials. USAW has not adopted any specific definition of harassment or abuse, choosing instead to defer to such general sources and definitions for reference and application, depending on the circumstances. As further elaboration of examples given above, the following generally describe conduct that may be considered harassment or abuse:

-Any improper or inappropriate comment, action or gesture directed toward a person or group that is related to race, ethnicity, national origin, religion, age, gender, sexual orientation, disability or other personal characteristic.

-Creating an environment through behavior or course of conduct that is insulting, intimidating, humiliating, demeaning or offensive.

-Harassment usually occurs when one person engages in abusive behavior or asserts unwarranted power or authority over another, whether intended or not, and may include, for example, name-calling, threats, belittling, unwelcome advances and requests for sexual favors (as well as undue pressure to perform or succeed).

-Harassment includes child abuse.

-Child abuse can include physical contact — or the threat of it — that intentionally causes bodily harm or injury to a child. This may include, for example, hitting, shaking, kicking, shoving, forcing an athlete to wrestle when injured or mandating excessive exercise as a form of punishment. It may also include touching for the purpose of causing sexual arousal or gratification that involves a child, rape, incest, fondling, exhibitionism and sexual exploitation. It may also include chronic attacks on a child's self-esteem, such as psychologically destructive behavior consisting of ridiculing, screaming, swearing, racist comments, threatening, stalking, hazing and isolating.

6. PARTICIPANT releases, waives any claims and promises not to sue the EVENT ORGANIZER and/or USAW with respect to any LOSS incurred during or in connection with his/her participation in the EVENT, any activities associated with the EVENT and the conduct and management of the EVENT (including as may result from the negligence of the EVENT ORGANIZER), except any LOSS which is the result of gross negligence and/or willful or wanton misconduct by the EVENT ORGANIZER. PARTICIPANT further agrees to hold harmless and indemnify the EVENT ORGANIZER and/or USAW from any claims brought against the EVENT ORGANIZER and/or USAW resulting from, arising out of or in any way associated with any LOSS.

7. Prior to participating in the EVENT, PARTICIPANT shall have the right to inspect the facilities and equipment to be used and, if PARTICIPANT discovers any condition which he/she reasonably believes to be unsafe, PARTICIPANT will immediately cause EVENT officials to be notified of such condition and will not participate in the EVENT so long as such condition exists.

BY SIGNING THIS DOCUMENT, PARTICIPANT ACKNOWLEDGES HAVING READ AND UNDERSTOOD ITS MEANING AND CONTENT &

Print Name of Participant _____

Signature of Participant _____ Date _____

Signature of Parent or Guardian _____ Date _____